

Fowler Plaza North

Tampa, Hillsborough County, Florida



Description:

Fowler Plaza North is a 25,619 square foot retail shopping center. The center's configuration provides for great visibility to Fowler Avenue. It is an excellent location next to the University Square Mall and half mile from the University of South Florida. Excellent access, signage and visibility on the Northeast corner of Fowler Avenue and Country Club.

Location:	2540-2576 East Fowler Avenue, Tampa 33612
Size:	25,619 square foot Shopping Center
Tenants:	Chipotle Mexican Grill and Mojo Books

Site Demographics:	Population	Households	Avg HH Income	Avg Age
3 Mile Radius:	133,165	53,995	\$41,017	34

Your Local Retail Leasing Solution, Since 1982



Office: (727) 347-5796 | Fax: (727) 345-5722 | P.O. Box 48547, St. Petersburg, Florida 33743
 Contact: Pauline A. Pappas | Email: prlm@prlminc.com | Visit us on the Web: www.prlminc.com

Fowler Plaza North

Tampa, Hillsborough County, Florida

SITE PLAN AND TENANT LIST

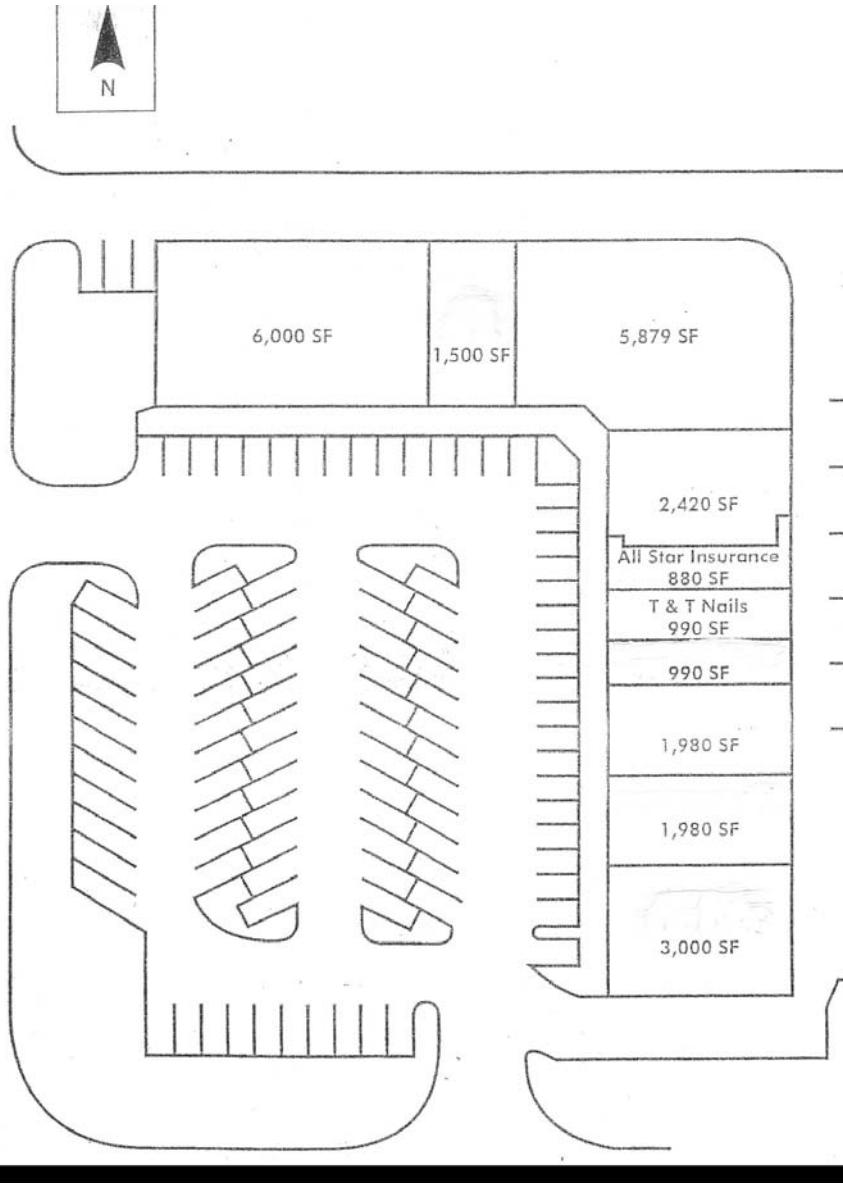

Square Footage	
4,000	Mojo Books
2,000	AVAILABLE - FORMERLY QUIZNO'S
1,500	AVAILABLE
5,879	I.Q. Outfitters
2,420	AVAILABLE
880	All Star Insurance
990	T & T Nails
990	AVAILABLE
1,980	CosmoProf
1,980	AVAILABLE
3,000	Chipotle Mexican Grill

Office: (727) 347-5796 | Fax: (727) 345-5722 | P.O. Box 48547, St. Petersburg, Florida 33743
 Contact: Pauline A. Pappas | Email: prlm@prlminc.com | Visit us on the Web: www.prlminc.com